

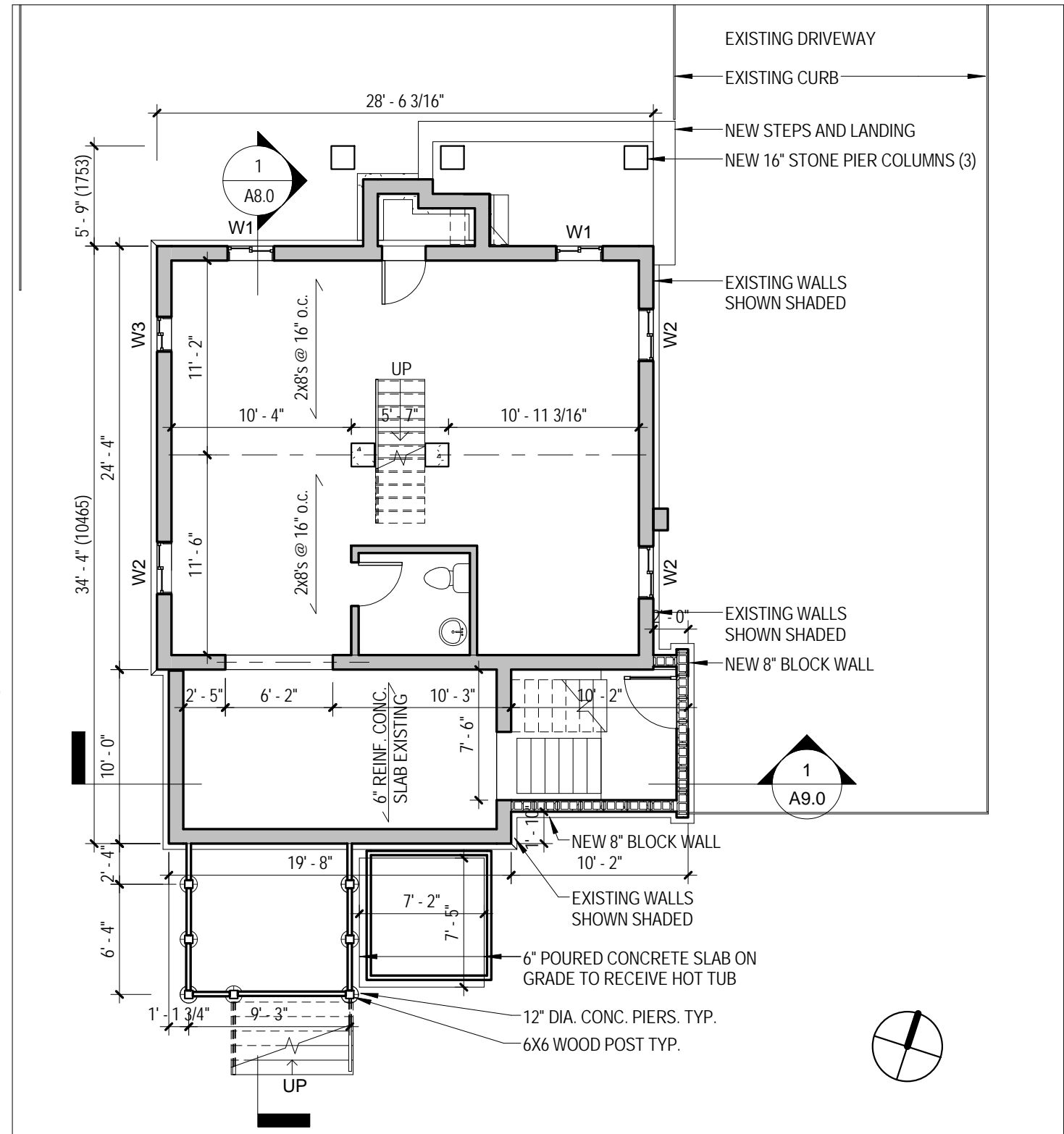

Existing back wall of house (South East corner)

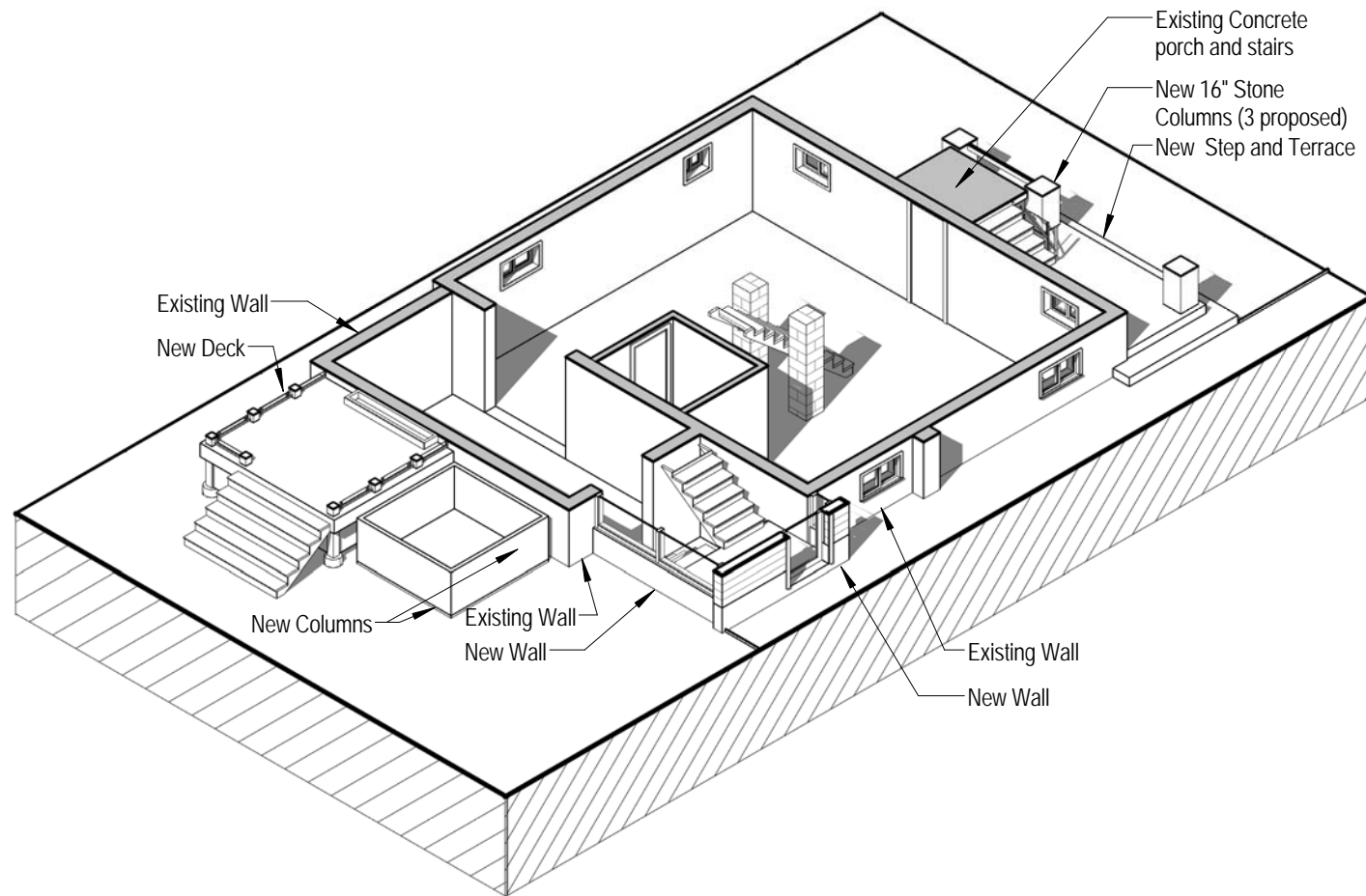

1 Basement
1/8" = 1'-0"

No.	Description	Date
1	Project Start	SEP 5, 2013
2	Submitted for Zoning Review	JAN 20, 2014
3	Submitted for Building Permit	MAR 31, 2014

295 Horsham Avenue
Toronto, Ontario

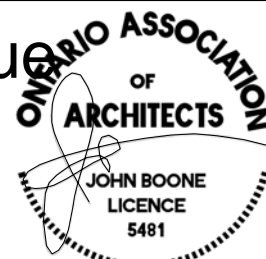

jba John Boone
ARCHITECT
51 Arundel Avenue, Toronto, Ontario, M4K 3A3
Tel: 416 469 3264 Email: johnboone@rogers.com

This drawing is the Property of John Boone Architect and may be used for this project only. Scale from drawings for reference only. Dimensions to be checked and verified by the contractor on site.

Basement		A2.0 Scale 1/8" = 1'-0"
Project number	13A14	
Date	March 31, 2014	
Drawn by	jb	
Checked by	jb	